

20140

(16140P)

94-98 GMC

20-BAR

BILLET INSERT



20140

(16140P)

94-98 GMC

20-BAR

BILLET INSERT

94-98 GMC Truck / 94-99 Suburban and Yukon 20 Bar Billet Insert

Tools Required:

Die Grinder with Cut-off Wheel or Jigsaw
Drill
1/8" Drill Bit
Pop Rivet Gun
File or Sand Paper

Hardware / Parts Included:

1 - Billet Insert (20 Bars)
5 - 1/8" Pop Rivets

Read and understand instructions before attempting installation

Step 1.

Remove grille shell from the vehicle (this requires removal of the 4 pc. corner lights also). Place the factory grille face down on a table. Carefully cut the center bars out of the factory grille inside the chrome (or black) plastic ring. Sand or file the edges smooth.

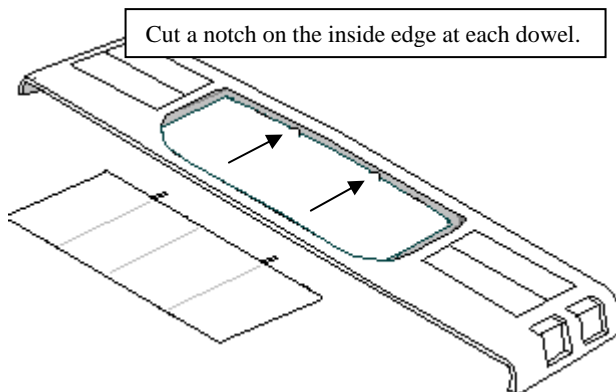

Step 2.

Place the billet insert behind the factory grille so the extended vertical dowels face up. Mark the location of the dowels to the inside edge of the opening on top. Cut a 1/4" "U" shaped notch at each location (**Do not cut the upper plastic edge on the very top of the grille**). This will allow the billet sit flush with the rear edge of the chrome ring.

Step 3.

Note the holes in the outer vertical bars on top and bottom. Center the billet in the grille. Then mark the location of the upright bars on top and bottom. Drill a 1/8" hole at each location (**Be sure to drill in the correct location**). Fasten a rivet through each hole to secure the billet insert in place. Re-install the grille shell back on the vehicle, close the hood, the job is finished. *Thank you for purchasing a T-Rex Billet Grille.*