

25440

**94-01 DODGE
RAM TRUCK
6 BAR - BILLET
BUMPER INSERT**



25440

**94-01 DODGE
RAM TRUCK
6 BAR - BILLET
BUMPER INSERT**

Tools Required:

Phillips Screwdriver
7/16" Wrench
7/16" Socket
Ratchet

Hardware / Parts List:

2	Bumper Inserts (6 bar)	4	1/4-20 x 3/4 Bolts
4	#10 x 1" Phillip Screws	4	1/4-20 Nuts
4	#10 Flat Nuts	4	1/4 Flat Washers
4	Extension Brackets	4	1/4 Lock Washers

Read and understand instructions before attempting installation

Step 1

The factory bumper inserts are held in by rivets and plastic tabs; Break these and remove the factory bumper inserts. Now attach the extension brackets to the inserts with the 1/4" fasteners (bolts, nuts & washers).



Secure this end to
the billet insert.

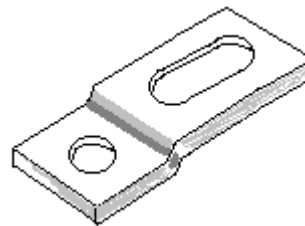

Step 2

Place each bumper billet in the bumper opening with the brackets on top. The extension brackets attach to factory holes in the bumper. Fasten using the #10 screws and flat nuts. The holes in the brackets are extended so you can adjust the billets in the bumper opening.



Step 3

Make sure the inserts are centered and tighten the fasteners.

Thank you for purchasing your T-Rex billet grille. 9/16/05